

Westwood

SERVICE BULLETIN

W03- 06

Date: 22/03/03

Models Concerned: 1986- 2001 Westwood Tractors

There are two types of grass roller assembly available for Westwood powered grass collectors built between 1986 and 2000.

Part numbers 3194 and 3194A.

Part no. 3194 is fitted to Powered Grass Collector models 7905 and 7955 and fixed into a roller housing.

Part no. 3194A is fitted to Powered Grass Collector models 4732, 3156 and 3000 and fixed in the "Tipping Frame" (cowhorn)

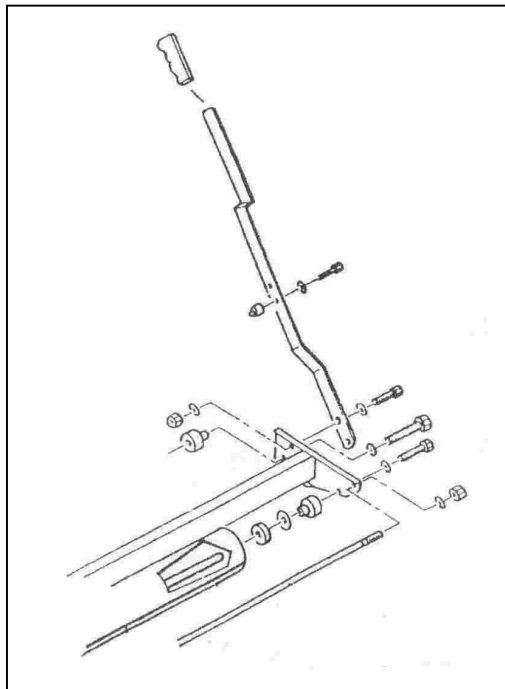

Grass Collector Models
7905 and 7955

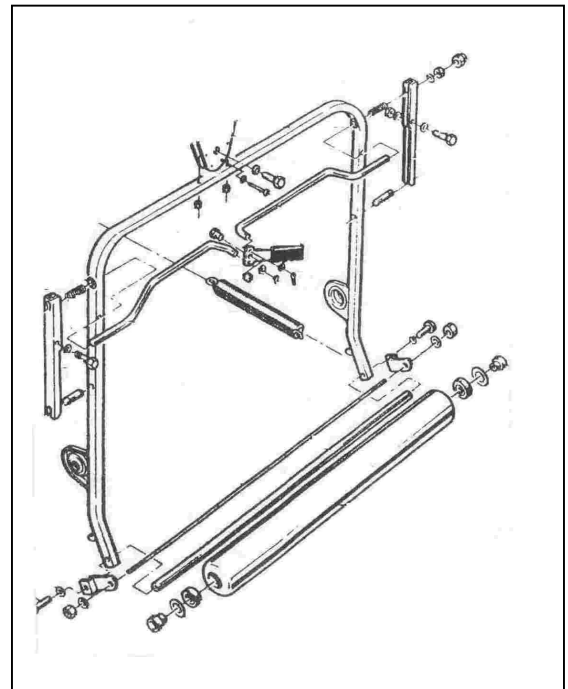

Grass Collector Models
4732, 3156 and 3000

Please contact Service department for any further information